

Runnymede Borough Council

ENGLEFIELD GREEN COMMITTEE

Tuesday 16th February 2016 at 7.00 p.m.

At the Jurgen Centre, Englefield Green

ADDENDUM

PART I

ITEM 4

CABLING WORKS ON THE GREEN

PROPOSED REVISED RECOMMENDATIONS

- 1. Subject to the agreement of the Crown Estate the Committee consents to works on the Green proposed by SSEPD and to any grant of an easement or wayleave as required by the Crown Estate subject to (1) the route of the cable being in the carriageway of Coopers Hill Lane; (2) all practicable steps are taken to protect any tree roots within the route and (3) reinstatement to the satisfaction of the Council**
- 2. Revised Report**
 - 2.1 SSEPD are looking to improve the security of electricity supply to the new development off Coopers Hill Lane (the Brunel development) Englefield Green by linking, using underground cabling, the Ridgemean substation and the existing 11KV cable at the entrance to the Brunel Development. The route is indicated by the broken blue line on the plan in **Appendix 'F'**. SSEPD are proposing to lay the cable, where possible, within the carriageway of the highway.
 - 2.2 SSEPD advise that as all the cabling works are in the carriageway they would be using the open cut trench technique which involves excavating a trench approximately 300mm wide by 850mm deep. Sand would be placed around the cable to protect it from sharp objects before backfilling and reinstating. In the vicinity of tree roots the trench would be hand dug. A site visit will be arranged to which a representative from the Council and the Crown Estate will be invited to attend.
 - 2.3 SSEPD has contacted the Crown Estate for agreement but owing to the short timescale such agreement has not as yet been received from the Crown Estate.
 - 2.4 SSEPD already has this Committee's Consent to carry out cabling works on the Green at Castle Hill (Englefield Green Committee 25 June 2013). These works are due to start on or about 1 March 2016 and are expected to take 4-5 weeks to complete. SSEPD are hoping to carry on with the cabling works in Coopers Hill Lane immediately after the cabling works in Castle Hill are completed
- 3 Legal Implications**
 - 3.1 The Crown owns the freehold of the Green and has the power to grant easements, wayleaves or consents to do works on the Green subject to the consent of this Committee. The Crown's consent is required before any works may commence.

- 3.2 Prima facie digging up the Green is a criminal offence under Section 12 of the Inclosure Act 1857, and a public nuisance under section 29 Commons act 1876. However, in DEFRA's guidance publication 'Management and Protection of Registered Town and Village Greens – Frequently asked questions (January 2010) it is stated that in considering whether any action contravenes either or both these statutes a court is likely to be concerned with whether material harm has been caused to the Green; whether there has been interference with the public's recreational enjoyment; the proportion of the green affected; and the duration of the interference. In this case it is likely to be a temporary disturbance and the Green will be reinstated so there will be no permanent interference with the public's recreational enjoyment. Accordingly, there should be little or no risk of prosecution under Section 12 of the Inclosure Act 1857 or under Section 29 Commons Act 1876.
- 3.3 At its meeting on 5 November 2013 this Committee authorised the adoption of a Procedure Note for Applications for the Grant of Third Party Rights and Works on the Green. Under that Procedure Note where the application is made in advance it should be directed to the Crown Estate and if the Crown Estate agrees to grant the right it will seek the consent of Runnymede Borough Council and a report will be presented to the next meeting of the Englefield Green Committee. In this instance the application has been made to the Crown Estate but consent has not been given owing to the short timescale. SSEPD have requested we seek consent subject to the agreement of the Crown Estate. It is open to this Committee to give consent subject to the agreement of the Crown Estate; or to refuse to give consent until the agreement of the Crown Estate is notified and when such consent is granted to utilise the emergency procedure under Standing Order 42 in the Constitution of the Council ; or to defer the decision to the next committee meeting on 21 June 2016 after the Crown Estate has made its decision.

Conclusion

- 4.1 SSEPD wishes to carry out all the cabling works in the area of The Green consecutively and owing to the timescales of the cabling works is seeking consent from this Committee subject to agreement being forthcoming from the Crown Estate

(TO RESOLVE)

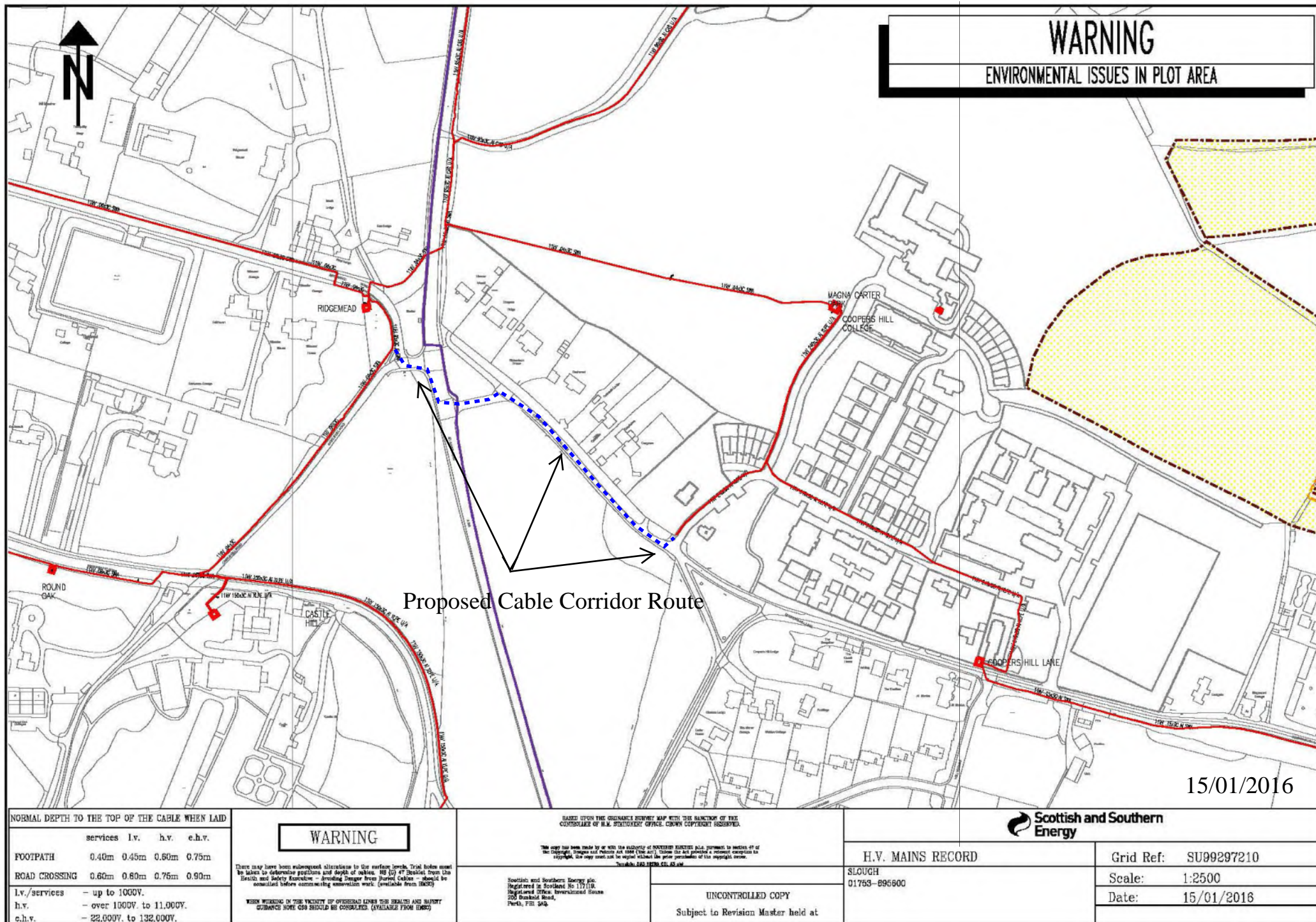

WARNING

ENVIRONMENTAL ISSUES IN PLOT AREA

Proposed Cable Corridor Route

15/01/2016

NORMAL DEPTH TO THE TOP OF THE CABLE WHEN LAID

	services	l.v.	h.v.	e.h.v.
FOOTPATH	0.40m	0.45m	0.60m	0.75m
ROAD CROSSING	0.60m	0.80m	0.75m	0.90m
l.v./services	- up to 1000V.			
h.v.	- over 1000V. to 11,000V.			
e.h.v.	- 22,000V. to 132,000V.			

WARNING

There may have been subsequent alterations to the surface levels. Trial holes must be taken to determine positions and depth of cables. If (c) 47 Denial from the Health and Safety Executive - avoiding danger from buried cables - should be consulted before commencing excavation work. (available from HSE)

When working in the vicinity of overhead lines the Health and Safety Commission Note C59 should be consulted. (available from HSE)

BASED UPON THE ORIGINATOR'S SURVEY MAP WITH THE SANCTION OF THE CONTROLLER OF H.M. STATISTICAL OFFICE. CROWN COPYRIGHT RESERVED.

This copy has been made by or with the authority of REGISTERED ELECTRICITY SUPPLY TO SECTION 47 of the Copyright, Designs and Patents Act 1988 (CDA 1988). Where the Act provides a remedy, copyright in the original, the copy must not be copied without the prior permission of the copyright owner.

Telephone: 0800 0200 011 43 44

Scottish and Southern Energy plc
Registered in Scotland No 117710.
Registered Office: 200 Bankhead Road,
Perth, F10 4AP.

UNCONTROLLED COPY

Subject to Revision Master held at

Scottish and Southern
Energy

H.V. MAINS RECORD

SLOUGH
01763-896600

Grid Ref: SU99297210

Scale: 1:2500

Date: 15/01/2016